

LakeWay
GOLDEN
HOMES

Marketing by





The Heart of a Vibrant
Centre Neighbourhood

The Lake way, Golden Homes

Welcome to our exquisite collection of downtown luxury apartments, where modern comfort meets urban sophistication. Nestled in the heart of the vibrant cityscape, our apartments offer an unparalleled living experience that caters to your every desire.

The lakeway golden homes will become one of the city's most distinctive landmarks. A magnificent architectural achievement.

Inside are living spaces that raise the benchmark for quality in hyderabad Subtle design and elegant finishes merge to create premium, contemporary homes.

Impressive communal facilities. Immediate access to expansive green space.

*The Lake way
Golden Homes is
quintessential city
centre living.*

DISCOVER THE PINNACLE OF CITY LIVING AT OUR LUXURY APARTMENTS.



KEY FEATURES:

- Best in Location
- Contemporary Design
- Panoramic Views
- Premium Finishes
- 24/7 Concierge
- Security and Privacy
- Cozy Community Atmosphere
- Connectivity
- Spacious Interiors
- Modern Amenities:





Our apartment complex boasts a variety of 2 and 3-bedroom flats designed to cater to your every need. Each home is thoughtfully designed to optimize space and functionality, providing a harmonious living experience for individuals and families alike.



LakeWay
GOLDEN
HOMES

Whether you're looking for a comfortable family home or a contemporary space to call your own, Lakeway Golden Homes offers a delightful living experience that caters to your lifestyle. Discover the perfect blend of luxury, convenience, and tranquility at Lakeway Golden Homes in Kompally, Hyderabad.

IN FOCUS:

LAKEWAY GOLDEN HOMES

Enjoy your day with your loved ones

Immerse yourself in the urban pulse while savoring the tranquility of your private oasis. Elevate your lifestyle and be part of a community that understands and caters to your every need. Contact us today to schedule a personalized tour and experience the essence of luxurious downtown living.

For investors, the opportunity to capitalise from this growth sector has never been more urgent.

3 Basic Points to Ponder Before

Planning your Dream Home!

Am I assured value for money?

Will it ensure a comfortable lifestyle?

Does the investment vouch for a secure future?

Will it ensure a comfortable lifestyle?

“Meticulously Planned keeping in mind contemporary lifestyles Lakeway golden homes is bestowed with a host of thoughtful facilities.”

HIGHLIGHTS

- ◆ Construction as per HMDA Norms
- ◆ Premium Quality Construction
- ◆ Best social infrastructure & Connectivity
- ◆ Aesthetic elevation & Vaastu Compliant
- ◆ parking areas in Stilt Floors
- ◆ Multi Purpose Hall, GYM, Suttle Courts, Children's play area solar lighting municipal water(if pipe line available)
- ◆ Intrecom Facility, power backup/inverter wiring
- ◆ Security Rooms & CC Cameras



CLASS. COMFORT. CONVENIENCE
Celebrate a Finer, Easier & Better Lifestyle



Electronic boom barrier gate



Elegantly furnished AC lobby



Well equipped AC fitness centre



Solid waste management



Children Play Area



AC multi recreation hall and party area



Guest Bedroom with AC Equipped



Rainwater harvesting



Access control entrance



Driver's room, janitor's room



AC association room



Terrace garden

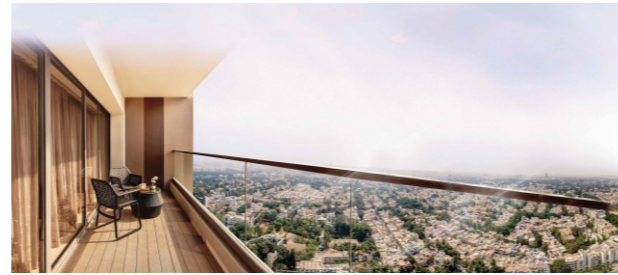

AMENITIES



Specifications

Foundations & Structure

RCC framed Structure with TMT Steel and branded 53 grade cement and Robo sand, ready mix or RCC up to 5.inch thickness for slab.
Red bricks with cement mortar. Branded. 43 grade cement, River sand and Robo sand.



Plastering

Two coats of plastering with sponge finish. All interior walls and ceiling with birla wall care or JK wall putty finish smooth finish for external walls and Texture in elevation side. Brand. 43 grade cement and River sand.



Fixtures and Fittings

Main Door and inner Doors Ready Made doors with best quality frame and doors and fittings. only main door and frame are made with teak wood
Hardware- standard bolts for internal doors. eurpoa/Godrej
locks for internal doors and standard central lock for main door
windows & French Doors- UPVC windows with elegantly
designed glass mesh and MS designed grill French Doors will be provided as per drawings and no grill for french doors.



Kitchen

Granite platform with stainless steel sink with both municipal and bore water provisions and ceramic tiles dado up to 2 to 3 ft height on the platform.
Provision for RO System, chimney or exhaust.



Toilets

Ceramic tiles (non-skid) flooring in all toilets and wall cladding with ceramic tiles up to door height will be provided taps and one wall mixture with shower of branded make of jaguar/cera! Provision for Geysers in all toilets. Wash basin in dining and one toilet and one Indian comboard and one or two Western comboards in toilets.



Sanitary and Plumbing

Sanitary material from CERA/Hindware or other standard make in toilets and otherplaces. Water Supply - CPVC piping from Ashirviad make and Drainage -PVC sanitary piping from Sudhakar make.



Painting

Birla wall care or JK putty will be used for internal finish. Interior walls are painted with Tractor/Premium Emulsion from Asian paints. Exterior faces of building will be painted with Aceor Apex from Asian paints and elevation with Texture and putty in outside.



Flooring

Vitrified tiles with nano finish of standard brand in all rooms standard size Plan ceramic tiles in balconies and toilets Vitrified or marble or granite flooring for stair cases and corridors VDF or good quality tiles in parking areas



Staircase to Terrace

Stair case from ground to terrace will be provided as per structural drawings with SS Railing.



Electrification

Best quality cables of Polyeab or Equivalent make and conduit pipes from Sudhakar or equivalent make. Adequate power points as per standard drawings shall be provided. Electrical provision of Geysers in bath rooms and in bed rooms. Switches from Anchor or other standard make.
One 3 phase meter per flat. Extra cost for fall ceiling wiring and extra electrical points.



Internet, Intercom and Television

Adequate points in necessary s places will be provided as per standard drawings with intercom facility.



Water Supply

required bore wells with motors and under round sump with required capacity and overhead storage tank with required capacity as per standard drawings. The facility for rainwater harvesting, supply of municipal water if pipe line's available.



Amenities

Branded Lifts of 6 persons with branded power backup generators. Car parking in the stilt floor, security room for the watchman, fall ceiling in the top floor.
Provision for Children's Play area, multipurpose hall and GYM room common to all blocks landscaping and security rooms for entire apartments complex security provisions generators transformers, water supply or bore wells water harvesting and common amenities or facilities etc can be made common for all blocks in the complex based on need power backup/Inverter wiring in flats



30' ROAD
30' ROAD
30' ROAD
30' ROAD



BLOCK - A

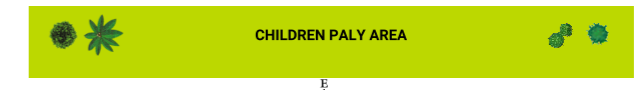

BLOCK - B RAMA RAJU RESIDENCY

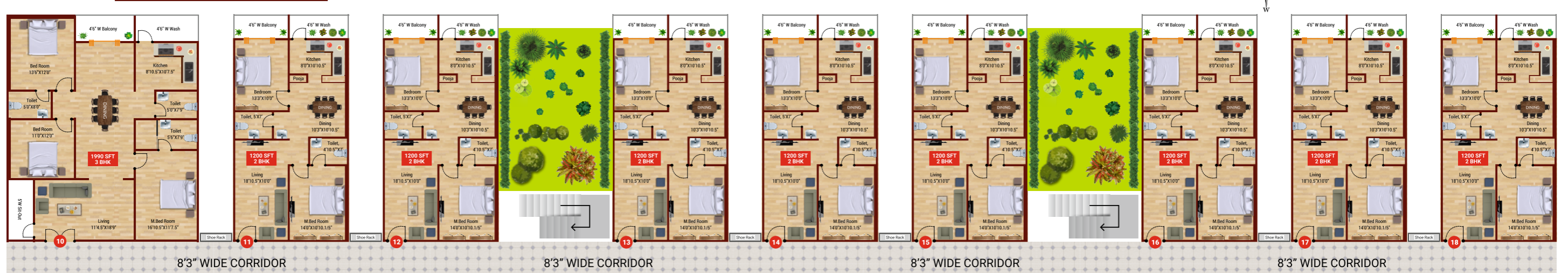

WHAT'S CLOSE TO YOUR HEART
IS NOW ALSO CLOSE TO YOUR HOME

Location Map

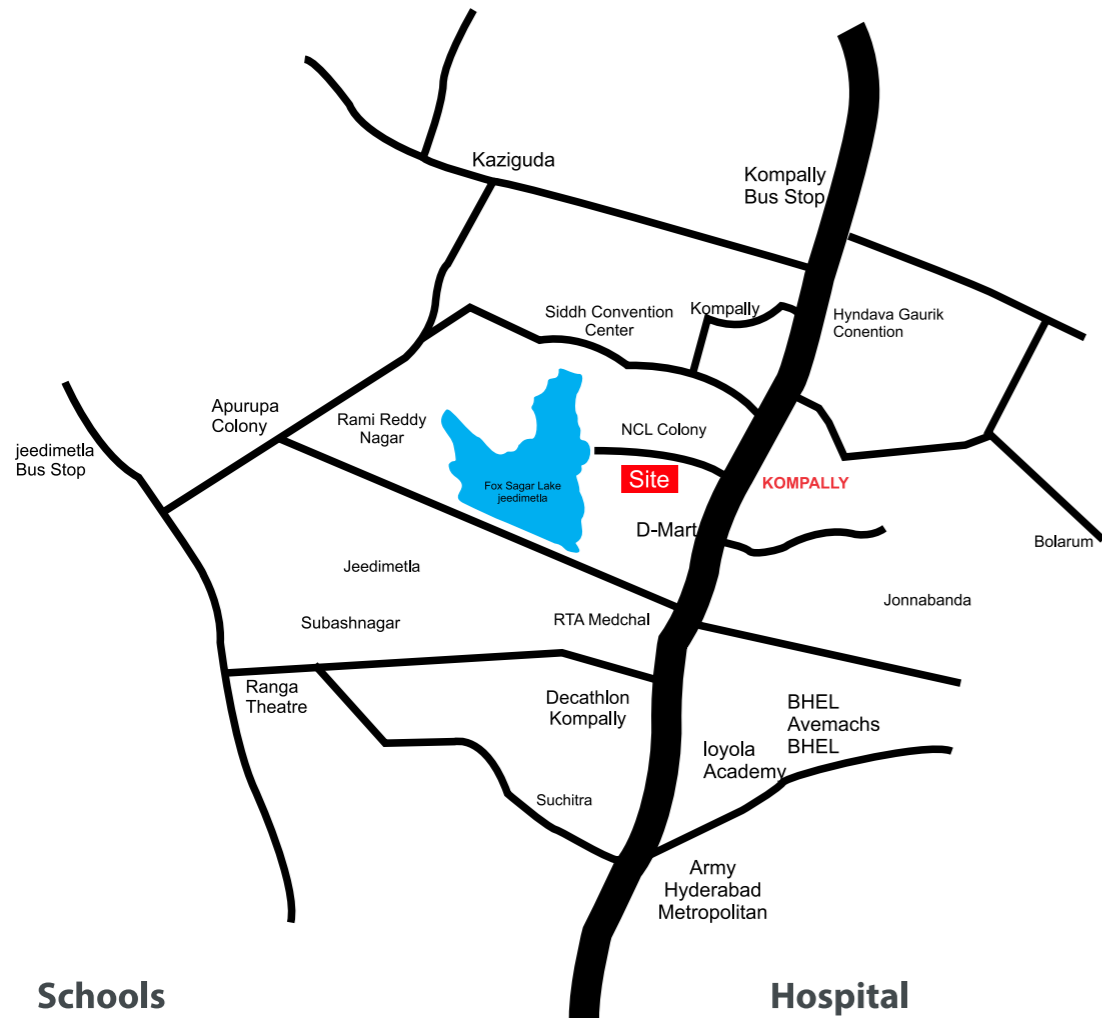

Schools

- Delhi International School
5 mins
- Cisne School
5 mins
- St. Anns School
10 mins
- Pearson School
10 mins
- Delhi World public School
5 min

IT parks

10-15 min

Hospital

- RS Hospital
9 min
- Renova Hospital
7 min
- Arke Hospital
6 min
- Srikara Hospital
6 min
- Aashrita hospital
10 min
- Russh Super Speciality Hospital
8 min

LIFTING DREAMS TO THE NEXT LEVEL
LEVEL
LEVEL

Get proud ownership of a dream home so full of ease, comfort and stylish elan that it's a perfect tribute to effortless living whichever way you look at it



Lake Way
GOLDEN
HOMES

Site Address:

Open Land, Sy No.106,110, NCL Colony,
Near Cine Planet Kompally, Hyderabad -67

Marketing by

